

Schichten

1, 3, 5, 7, 9, 11, 13, 15

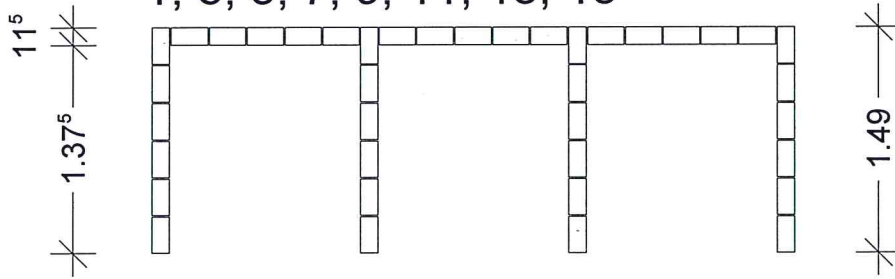

$$39 \text{ Steine} + 8 \\ = 312 \text{ Steine}$$

Schichten

2, 6, 10, 14

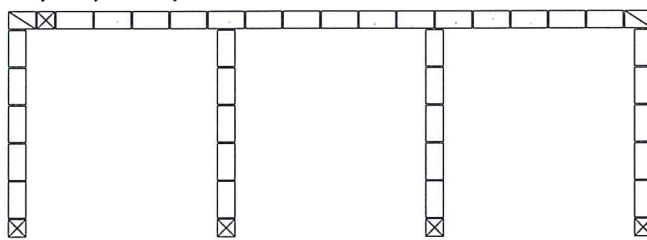

$$40 \text{ Steine} \cdot 7 \\ = 280 \text{ Steine}$$

Schichten

4, 8, 12

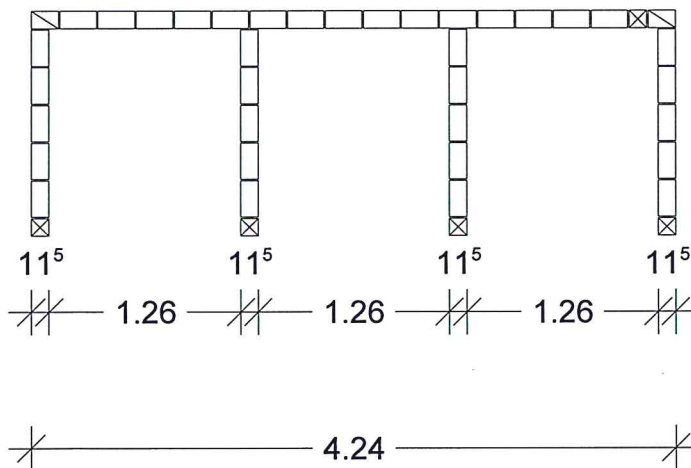

Höhe 1,25m

15 Schichten

Schichthöhe 8,33cm

3 Schichten entsprechen 25cm

Materialbedarf = 592 Steine

Mörtel 50 l/m²

1 Stein = 0,021 m²/Stein

= 627,60 l = ca. 20 Sand